

CRP-RH18-20 (Harmonic)

INDUSTRIAL ROBOT

HANDLING

APPLICATION



FUNCTIONAL FEATURES

- With compact design 20kg payload and about 1.8 meters arm span, it can be installed on the ground or upside down flexibly.
- With large working space and fast running speed, it is suitable for welding, spraying, loading and unloading, handling, sorting, assembling and other applications.
- The safety emergency stop board is independent of the controller, and the safety relay circuit is adopted to provide double circuit emergency stop to ensure the reliability of emergency stop.
- The robot body cables are made of special cables for highly flexible robots.
- Built-in three-phase transformer, 380V and 200V isolation, more stable power supply.
- Power supply requirements can be customized for different countries. Built-in three-phase filter can effectively improve the performance of EMC and EMI.
- The robot body is with dual-circuit gas pipe and meets welding and handling requirements.

ROBOT BODY TECHNICAL PARAMETERS

Model	CRP-RH18-20	
Arm form	Vertical multiple joints	
Degree of freedom	6 axis	
Maximum payload	20kg	
Repeated positioning accuracy	±0.08mm	
Maximum reaching distance	1730mm	
Robot body weight	285kg	
Installation mode	Ground, upside down mounting, wall mounting	
Maximum travel	axis 1	Ground/upside down mounting -167°~167°, wall mounting -30°~30°
	axis 2	-45°~175°
	axis 3	-80°~155°
	axis 4	-190°~190°
	axis 5	-125°~125°
	axis 6	-360°~360°
Maximum speed	axis 1	160°/S
	axis 2	160°/S
	axis 3	169°/S
	axis 4	301°/S
	axis 5	342°/S
	axis 6	520°/S
Allowable torque	axis 4	55N.m
	axis 5	55N.m
	axis 6	30N.m
Allowable moment of inertia	axis 4	2.2kg.m²
	axis 5	2.2kg.m²
	axis 6	1.2kg.m²
Installation environment	ambient temperature	0~45°C
	relative humidity	20~80%(No condensation)
	vibration	Under 0.5 G
	Others	Robot installation must be away from: Flammable or corrosive liquids or gases, electrical sources of interference
IP level	Body IP54 , wrist IP67	
Advantage features	Compact structure, high speed, high precision, high expansibility and easy operation	
Application	cutting, assembly, handling, marking, grinding	
Electric Cabinet Configuration	G4/G5+External Transformer	

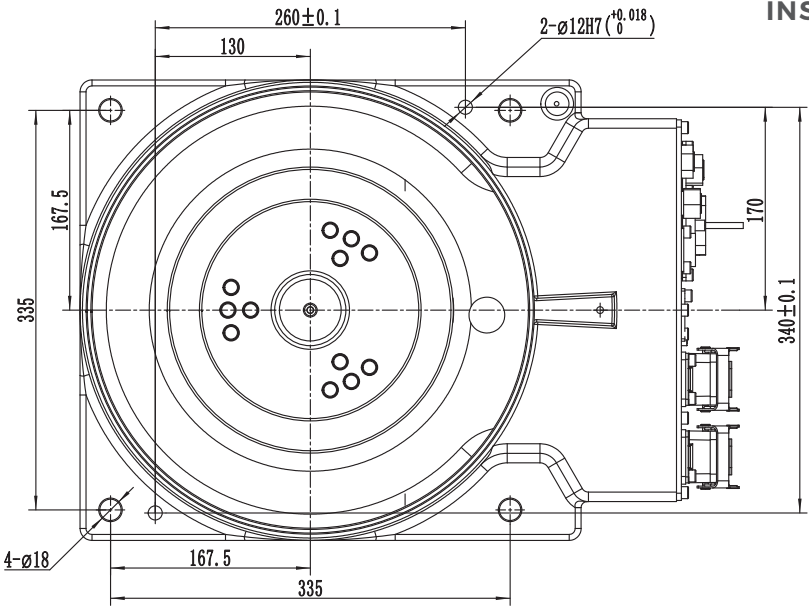

Installation Dimension of Base

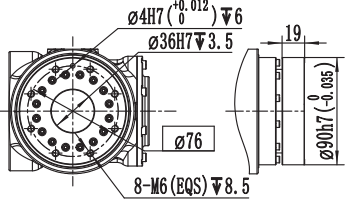

Flange Dimensions

MOTION RANGE DIAGRAM

